

SLED-FG-M1/8II

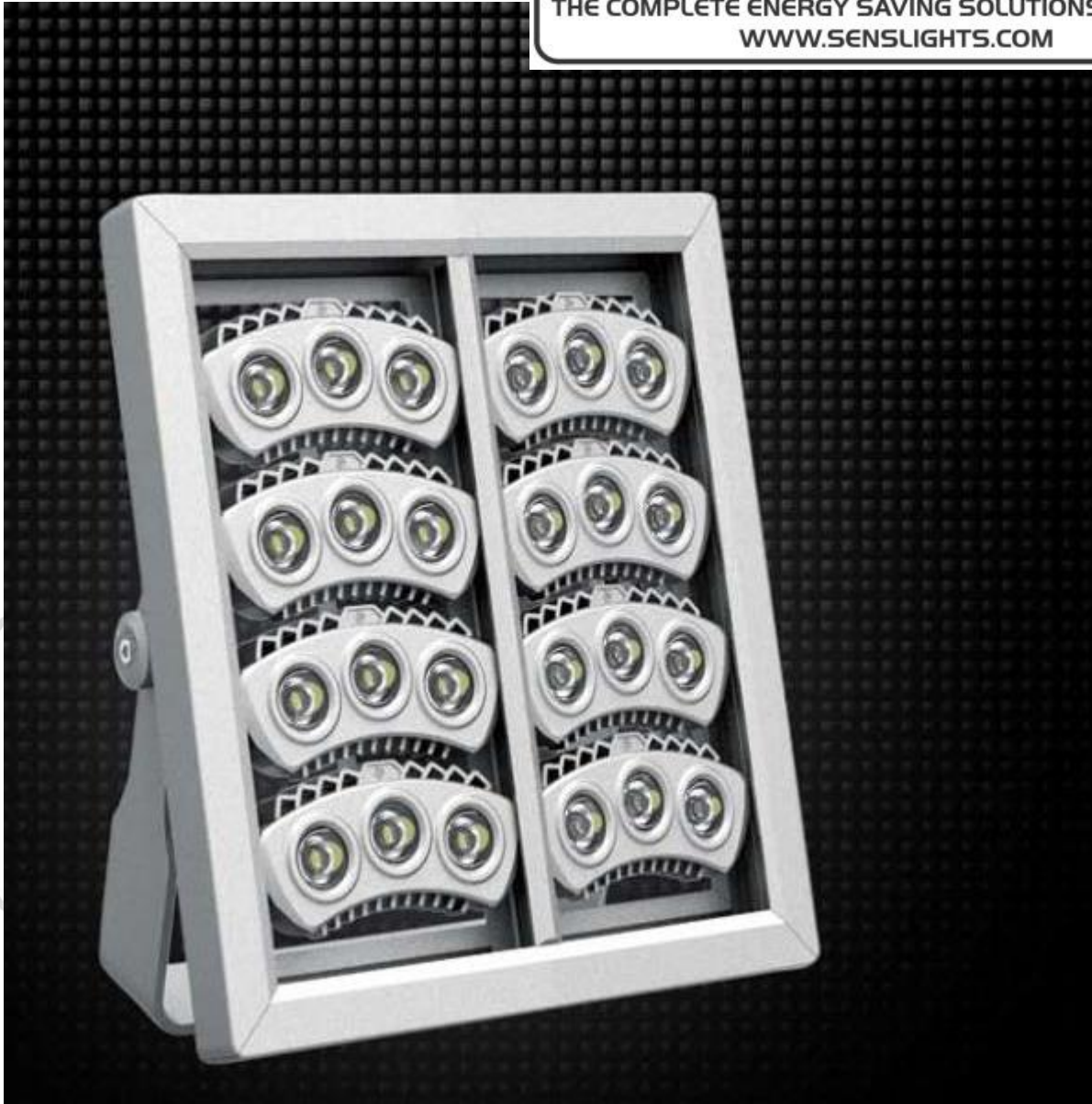

SENS LIGHTS
THE COMPLETE ENERGY SAVING SOLUTIONS PROVIDER
WWW.SENSLIGHTS.COM



www.senslights.com



Email: info@senslights.com

Product Size

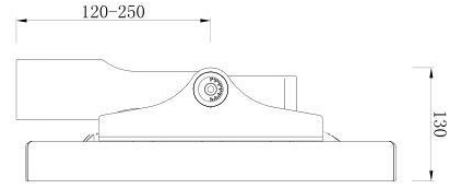
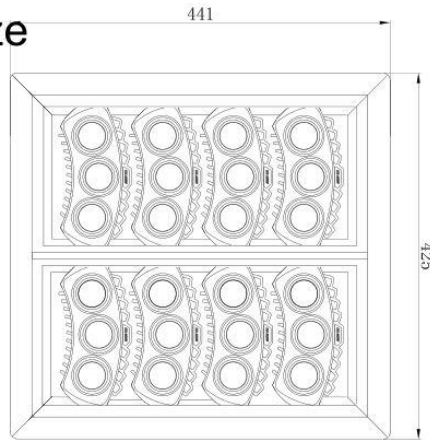

model type	L	W	H
DLD-FG-M1/8 II	441mm	425mm	130mm

Light distribution curve

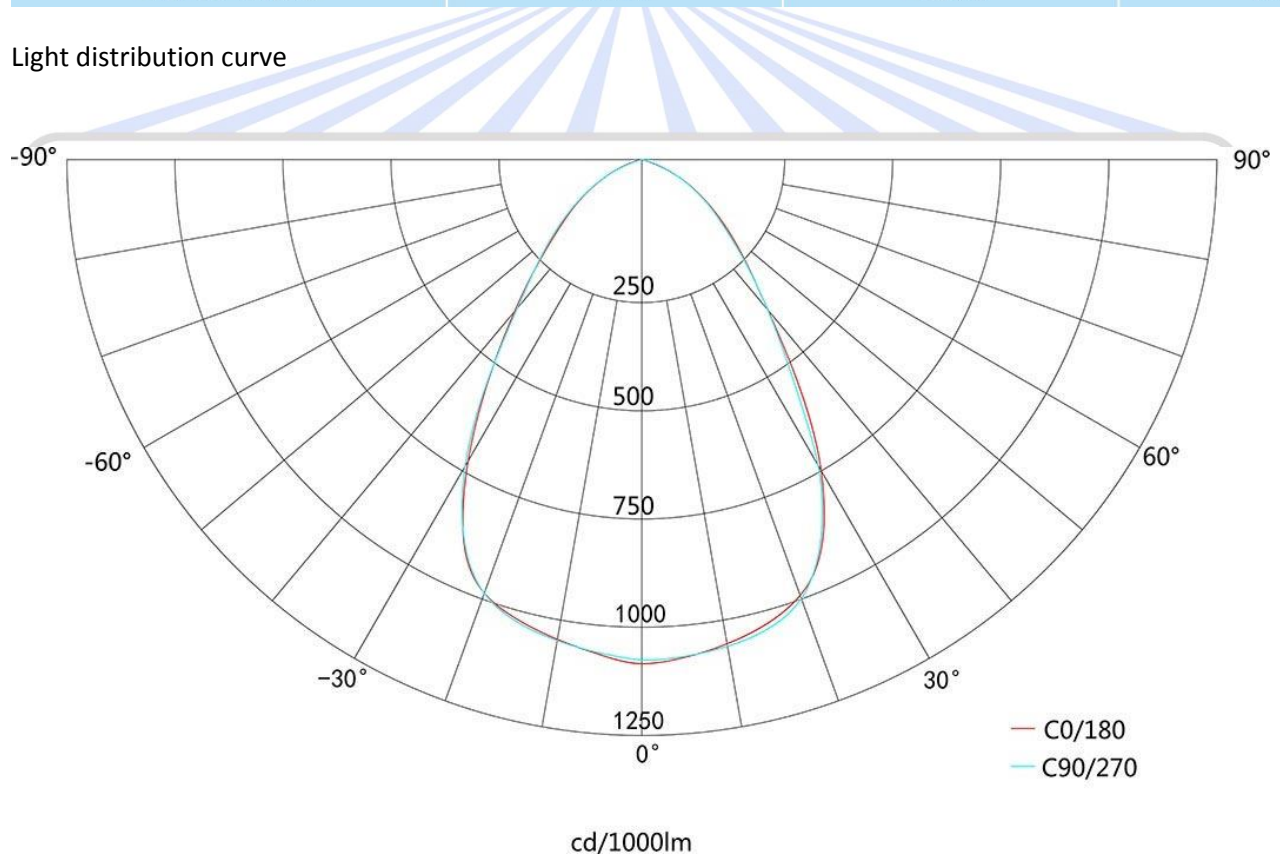

www.senslights.com



Email: info@senslights.com

Products Features:

- The whole light consists of light module,radiator,heat-conducting medium,electric box,mounting bracket and etc.

The radiator of the light source and the driver is separate.

- Module radiator used ventilation of vortex streamline in bionics.

The radiator fin makes the air convect and run through the whole fins.

The design of asymmetric diversity fins make the flowing air bring the heat of the fins.

The modular design can avoid the heat island effect,and with high pressure die-cast aluminium-magnesium alloy material,effectively improved the cooling efficiency to extend the service life of the light source.

- For the light source,the aluminium board and radiator is seamless through high conductive medium. It can quickly pass to the air via radiator,effectively control the temperature of the LED and highly extended the service life of the light source.

- The radiator of the light source and the driver is separate and independent,so the heat between them doesn't interact and then extend the service life of the light source.

- For the light source,we use the international top LED chips with high luminous efficiency,longer service life and excellent CRI.

- Application : soccer pitches,outdoor building external walls, billboards, sculpture,high pole lighting of square and etc.

<p>Technical parameters:</p> <ul style="list-style-type: none"> *Model: SLED-FG-M1/8II *System power: 200W-240W; *Power coefficient:≥0.95; *System light effect: > 100 lm/W; *Color temperature: 2500K-6500K or customized; *CRI: >70; *Working voltage:AC 85-265V 50-60Hz or customized; *Protection level: IP65; 	<ul style="list-style-type: none"> *Electrical safety grade: Class II *LED: CREE / BRIDGELUX or customized *Driver:INVENTRONICS or customized; *Driver efficiency: 92%; *LED numbers: 24 pcs COB; *Single LED power: 10W per COB; *Beam angle: 24°/ 38°/ 60°; *Working environment temperature: -25°C -- +60°C; *Service life time L70 >50,000 hrs; *Quality warranty:3 years; *Size:440*425*130mm;
--	---



www.senslights.com



Email:info@senslights.com